

White

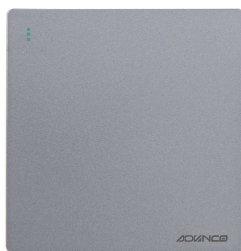

Grey



Gold



Black

# K12



## Frame module

It can be taken apart easily to change the design rather than change the whole set



## U type terminal

U type threads structure with large-diameter terminal can fasten connection

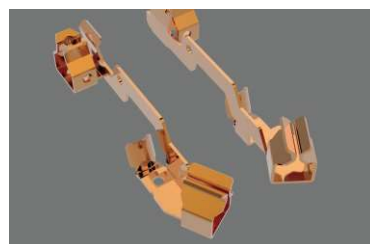

## Bronze conduction

One-time finished tin-phosphor bronze metal part. Strong resilience. Resistance to wear. Lifetime 1.5 times longer than product itself



## PC material

High quality imported Bayer PC  
Good fineness  
Uniform color  
No color change for 10 years



## Children safety guard

Safety guard set inside to protect children from electric shock accident



## Access port

Easy to put in 3pcs of wires  
Convenience for installation

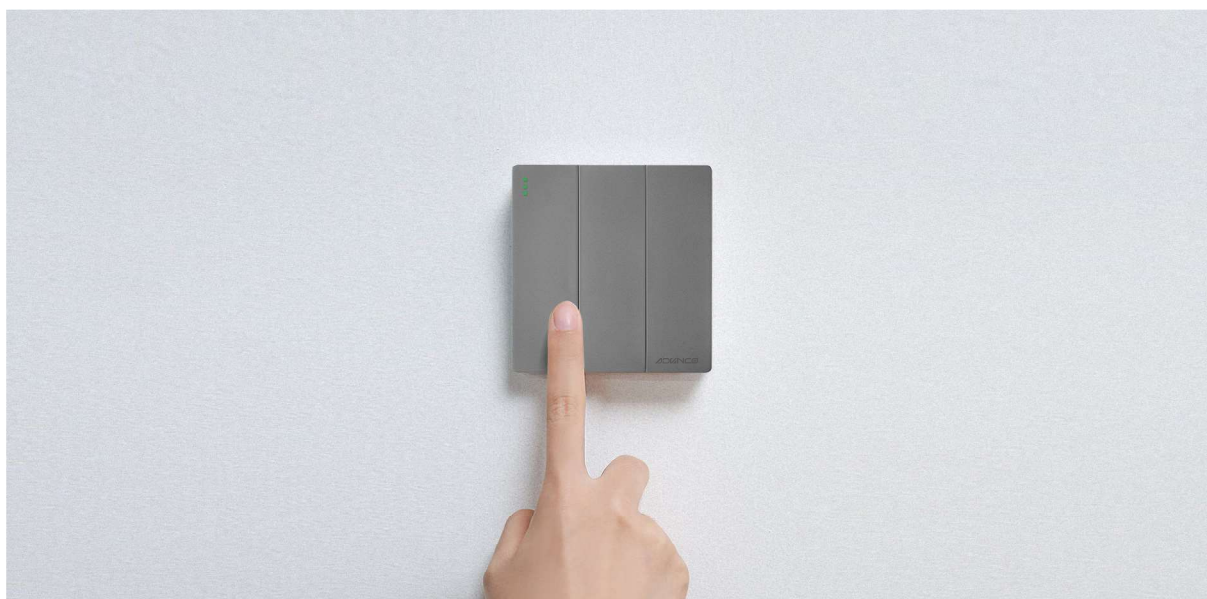

# K12



Power : 16AX 250V~  
**K12.01Q/1Y** : 1 Gang 1 Way Switch  
**K12.01Q/2Y** : 1 Gang 2 Way Switch  
**K12.0DK** : 1 Gang Multi-point Control Switch



Power : 16AX 250V~  
**K12.02Q/1Y** : 2 Gang 1 Way switch  
**K12.02Q/2Y** : 2 Gang 2 Way switch  
**K12.0DK2** : 2 Gang Multi-point Control Switch



Power : 16AX 250V~  
**K12.03Q/1Y** : 3 Gang 1 Way switch  
**K12.03Q/2Y** : 3 Gang 2 Way switch



Power : 16AX 250V~  
**K12.04Q/1Y** : 4 Gang 1 Way switch  
**K12.04Q/2Y** : 4 Gang 2 Way switch



Power : 16A 250V~  
**K12.0ML** : Door bell



Power : 16AX 250V~  
**K12.0MH/2** : "DON' T DISTURB" & "MAKE UP ROOM" Indicator Bell Switch



Power : 16A 250V~  
**K12.01K/2J-D20** : 1 Gang 20A DP Switch  
**K12.01K/2J-D32** : 1 Gang 32A DP Switch  
**K12.01K/2J-D45** : 1 Gang 45A DP Switch



Power : RJ45 Cat6  
 Power : RJ114Wire  
**K12.0DH/DN** : Television & computer socket



Power : 5~850MHz  
**K12.0WXTV** : Satellite television



Power : <5~850MHz  
**K12.03TV** : 1 way television socket  
**K12.0KPTV** : F-type Satellite Socket  
**K12.0KPTV/1** : Secondary F-type Satellite Socket



Power : RJ45 Cat6  
**K12.0DN** : 1 way computer socket



Power : RJ114Wire  
**K12.0DH** : 1 way telephone socket

# K12



Power : 5~850MHz  
 Power : RJ114Wire  
**K12.0WXTV/DH** : Satellite TV& telephone socket



Power : RJ45 Cat6  
 Power : 5~850MHz  
**K12.0WXTV/DN-6** : 1 way Satellite TV& computer socket



Power : RJ45 Cat6  
 Power : 5~850MHz  
**K12.0TV/DN-6** : Television & computer socket



Power : 5~850MHz  
 Power : RJ114Wire  
**K12.0TV/DH** : Television & Telephone socket



Power : 16A 250V~  
**K12.01633MS** : 2 Gang US Socket



Power : 16A 250V~  
**K12.01633MS** : 1 Gang US Socket



Power : 16A 250V~  
**K12.01K/2YDGN-D16** : 2 gang 2&3 Pins Universal switched socket with indicator



Power : 16A 250V~  
**K12.0K/DGN-D16** : 1 Gang Universal Switched Socket with Indicator



Power : 16A 250V~  
**K12.01K/DGNUSB2-D16** : 1 Gang Switched Unicersal socket with 2 USB Port



Power : 16A 250V~  
**K12.0DGN** : 1 Gang Switched Unicersal



Power : N/A  
**K12.0FHU** : HDMI+USB Socket  
 ( USB for data transfer )



Power : N/A  
**K12.0FV** : VGA+F3.5 Socket

# K12



**Input** : 10A 220V~  
**Output** : PD20W



**Power** : 220V~ LED≤100W  
**K12.0TG/T** : Rotatable Dimmer Switch



**Input** : 10A 220V~  
**Output** : PD20W



**Power** : 220V~ ≤300W  
**K12.0TS** : Fan Speed Controller Switch



**Power** : N/A  
**K12.0BJ** : Alarm Press Button Switch



**Power** : LED≤60W  
**K12.0SGK/Y** : Acoustic light switch



**Power** : LED≤60W  
**K12.0HW/Y** : PIR motion sensor switch

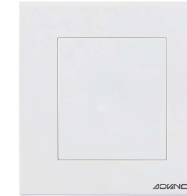

**Power** : N/A  
**K12.0MB** : Front-plate



**Power** : 16A 250V~  
**K12.0JK** : Energy Saving Card Switch  
**K12.0JK/G** : High frequency IC card Switch  
**K12.0JK/D** : Low frequency IC card Switch

# K12



Power : N/A  
K2.0286TB : one-piece frame assembly  
( can instam both horizontal and vertical side )



Power : N/A  
K2.0386TB : one-piece frame assembly  
( can instam both horizontal and vertical side )



Power : N/A  
K2.0586TB : one-piece frame assembly  
( can instam both horizontal and vertical side )



Power : N/A  
K2.0486TB : one-piece frame assembly  
( can instam both horizontal and vertical side )

## Series Features

1. Color: White, Champagne Gold, Brushed Silver.
2. 86\*86MM & 86\*146MM size. Frameless design. Round Edge.
3. High-quality PC material. Flame retardant, high strength, high temperature resistance, not easy to fade.
4. Precise structure , switch faceplate all in one, easy to assemble and dismantle.
5. Hot silver Logo . Fashionable and attractive.